

CATALOG





WHO ARE WE?



Litecon is a producer, importer and marketer of Autoclaved Aerated Concrete (AAC) panels and blocks.

☰ **Litecon** is partnered with **Aircrete Mexico** and **Aircrete Europe**, a global leader in AAC with more than 50 years of experience, known as the most advanced developer, manufacturer and producer of AAC technology. The company has built over 100 different plants in 20 countries on 6 different continents.

☰ We are the future of panels for walls and facades for residential, commercial and industrial buildings.

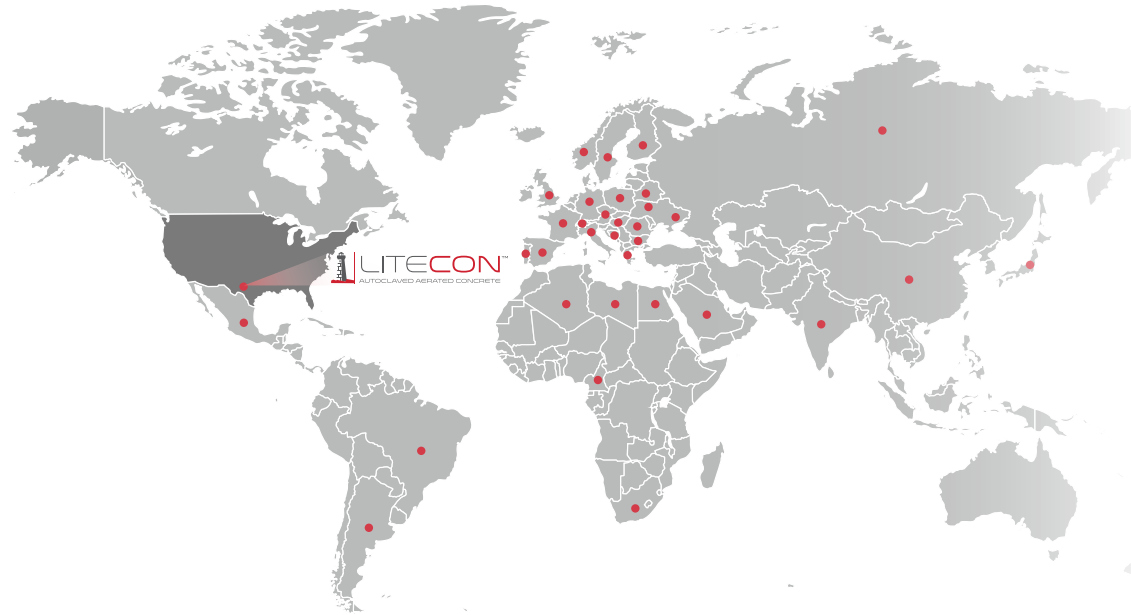



WHAT IS AAC?

- ☰ **Autoclaved Aerated Concrete (AAC)** is a lightweight and ecofriendly concrete, commonly known as cellular concrete.
- ☰ AAC is manufactured with cutting-edge technology and natural materials such as: cement, lime, silica sand, and aluminum powder.
- ☰ AAC products include prefabricated panels and blocks of various sizes.

“ AAC products are made 100% of natural materials, containing no foam or plastics. ”





OUR FACTORY



- ☰ Our product is manufactured at the **newest** and **largest AAC plant** in **North America** with an annual production capacity of **32 million ft²**.
- ☰ We are currently shipping panels and blocks all over **North America** and **Central America**.



LOCATION / 20 MILES NORTH MEXICO CITY



 **LITECON**™
AUTOCLAVED AERATED CONCRETE



BENEFITS TO THE BUILDER & GENERAL CONTRACTOR



ROBUST CONCRETE

Strong, durable
& weather
resistant



STRUCTURAL

No need for
plywood or OSB



LIGHT WEIGHT

Weighs 60%
less than
conventional
concrete



HIGH QUALITY MANUFACTURING

Manufactured to
meet ASTM
standards



ECO-FRIENDLY

LEED
Evaluated
[Click here for
LEED Dossier](#)



EASIER & FASTER INSTALLATION

Prefabricated
panels easy to
cut and sand
with conventional
tools



LOWER COST

Savings up to
40% less



BENEFITS OF THE **HOME OWNER**



ROBUST MATERIAL

Strong exterior
wall
(No need for
blocking)



LONG LASTING

Does NOT
deteriorate or
crack over
time



FIRE RESISTANT

Up to 2hr fire
resistance*

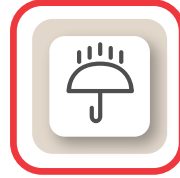

WEATHER RESISTANT

Water resistant,
does not form
mold

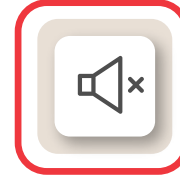

ACOUSTIC INSULATION

Reduces sound
up to 57 STC*

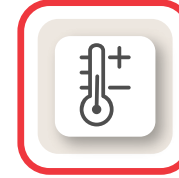

THERMAL INSULATION

Superior
continuous
insulation



ENERGY SAVINGS

Energy bill up
to 40% lower

**Panel 3"*

R VALUE

Litecon: 2.3
3- Coat stucco: 0.20
Fibre Cement: 0.37
Cement Board: 0.3



SUPER SMOOTH FINISH

☰ **Second cutting edge Technology** patented by **Aircrete®**

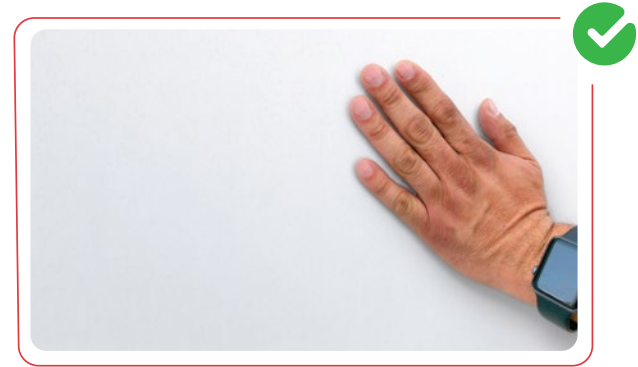
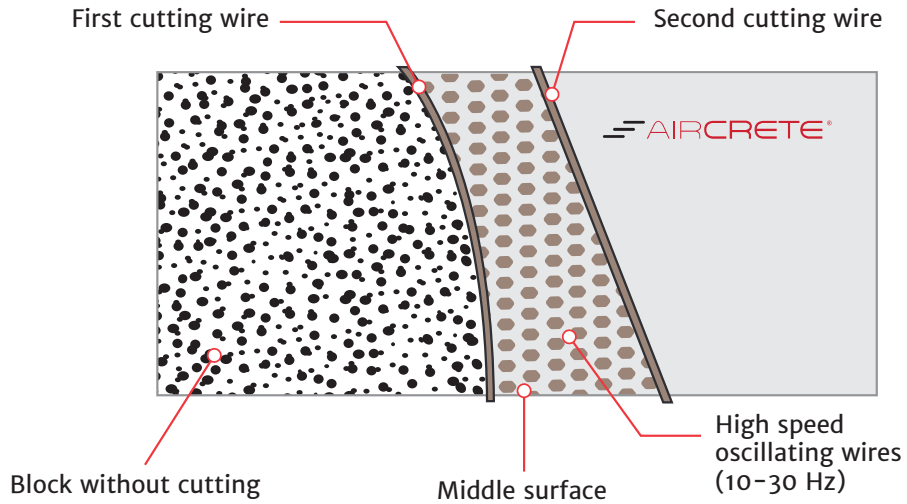

Leaves a super smooth finish, leading to savings on finish coats



OUR PRODUCTS

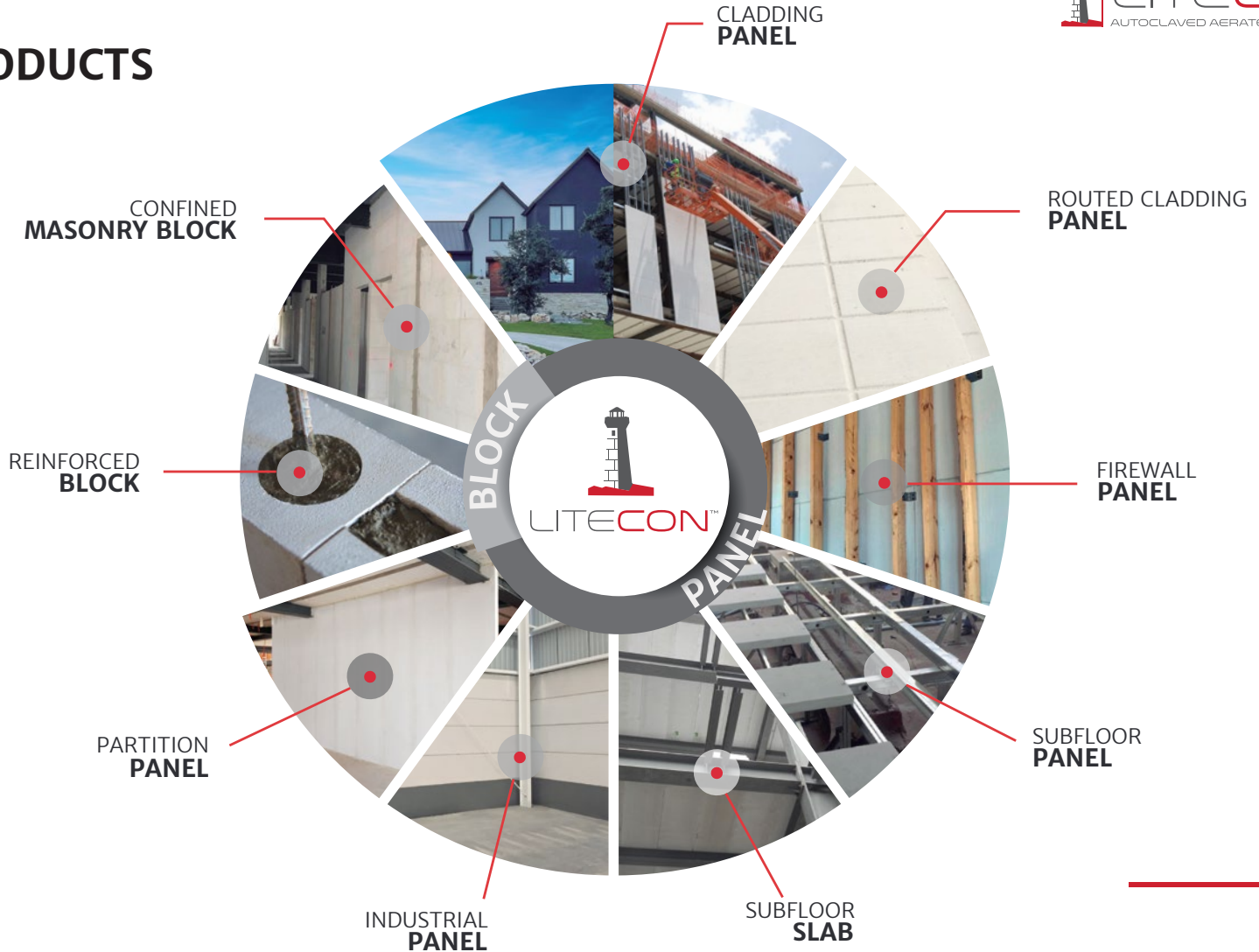

CLADDING PANEL





CLADDING PANEL



DESCRIPTION:

Cladding Panels for traditional wood or steel frame system.

ADVANTAGES:

- ≡ R-Value: 2.3 Continuous insulation (vs Stucco 0.2 and Fiber cement siding 0.3)
- ≡ Fast installation (700 ft² a day per 2-3 person crew)
- ≡ Any finish can be applied: Stucco finish, plaster, veneer, sticky brick, brick, stone, siding
- ≡ Super smooth finish great for savings on finish coat
- ≡ Does not sag, warp, deform or crack (joints remain invisible over time)

APPLICATION:

Litecon Cladding Panel is the sheathing and exterior wall. To install, directly fasten to wood or steel frames.

WEIGHT:

5.12 lbs/ft²

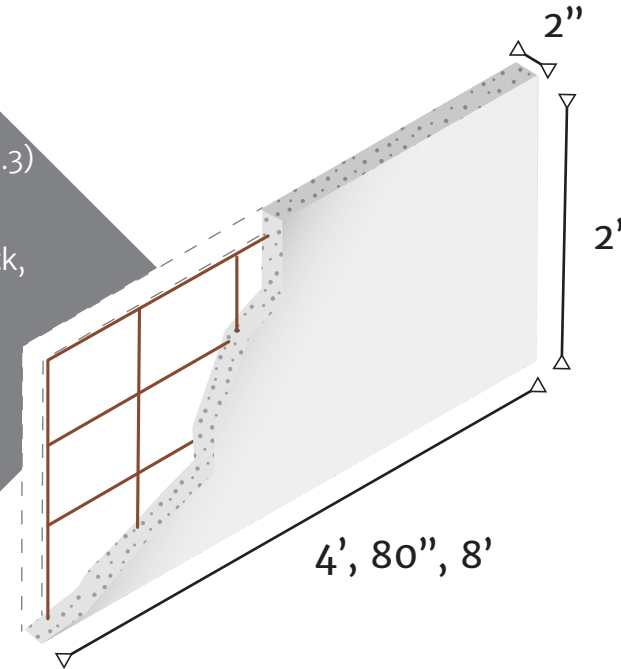

Standard sizes 2" thick by 2'x4', 2'x80" & 2x8'. Steel reinforced with an 1/8" steel mesh.

ROUTED CLADDING
PANEL



DESCRIPTION:

Routed cladding panel with custom pattern design.

ADVANTAGES:

- ☰ Custom designs available
- ☰ Easy finish: simply apply primer/sealant and paint
- ☰ Does not sag, warp or crack (joints between panels remain invisible over time)
- ☰ Uniform look with smooth finish

APPLICATION:

Litecon Cladding Panel is the sheathing and exterior wall. To install, directly fasten to wood or steel frames.

WEIGHT:

5.12 lbs/ft².

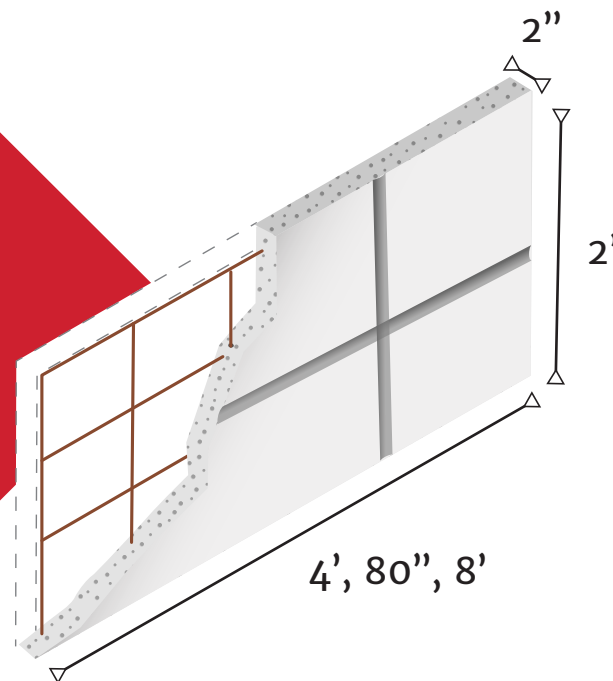

Standard sizes 2" thick by 2'x4', 2'x80" & 2'x8'. Steel reinforced with an 1/8" steel mesh.

LITECON FIREWALL
PANEL





LITECON FIREWALL PANEL



DESCRIPTION:

Specially crafted AAC 2"-3" Panel for Firewalls.

ADVANTAGES:

- ≡ Fast installation during framing, no need for specialized labor
- ≡ Complies with 2 hour fire rating
- ≡ Highly acoustic, reduces 57 STC

APPLICATION:

Sound absorbing 2 hour Firewalls, Shaftwalls, Area Separation Walls, Demising Walls and Party Walls.

WEIGHT:

5.12-7.68 lbs/ft².

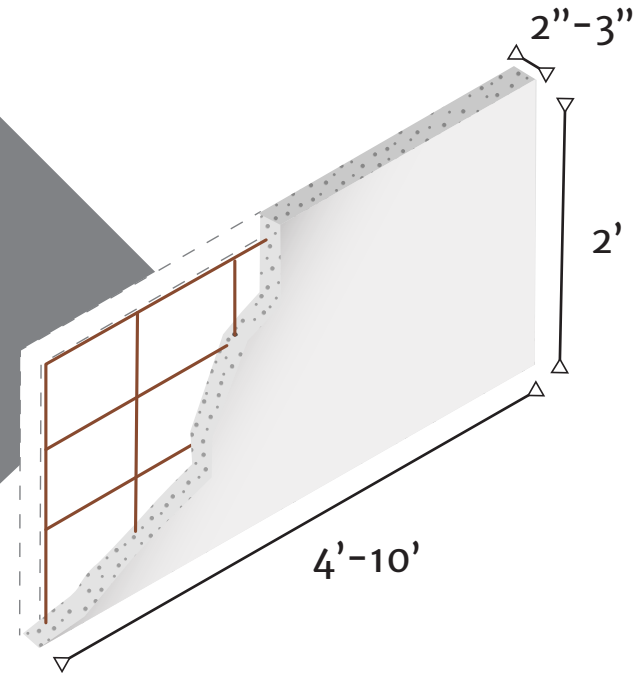

Standard sizes 2"-3" thick x 2' x 4'-10'

SUBFLOOR
PANEL



SF|P

SUBFLOOR PANEL



DESCRIPTION:

Steel reinforced floor panel to accommodate supports at 16" or 24" O.C.

ADVANTAGES:

- ☒ Fast installation
- ☒ Non labor intensive: no sanding needed to level subfloor
- ☒ Fire resistant
- ☒ Highly acoustic
- ☒ Any type of flooring can be applied directly

APPLICATION:

Floor panels are directly fastened over wood or steel joists. No need for plywood.

WEIGHT:

5.12 lbs – 7.68 lbs per ft².

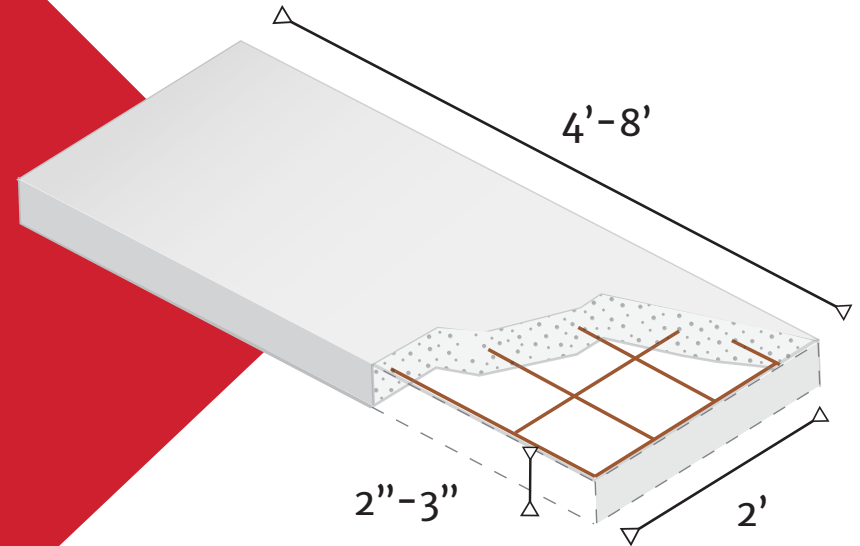

Standard sizes 2" – 3" thick x 2' x 4' – 8'.

SUBFLOOR
SLAB



SUBFLOOR SLAB



DESCRIPTION:

Steel reinforced subfloor slab. Designed to be placed over steel supports at greater separation.

ADVANTAGES:

- ≡ Fast Installation
- ≡ Reduces structural costs due to light weight
- ≡ Requires less framing (allows for more separation between supports)
- ≡ Eliminates on-site casting for sturdy subfloor

APPLICATION:

Subfloors.

Panels can be attached directly over steel frames, concrete or confined masonry walls.

WEIGHT:

12.3 lbs/ft² for 4" thick panel.

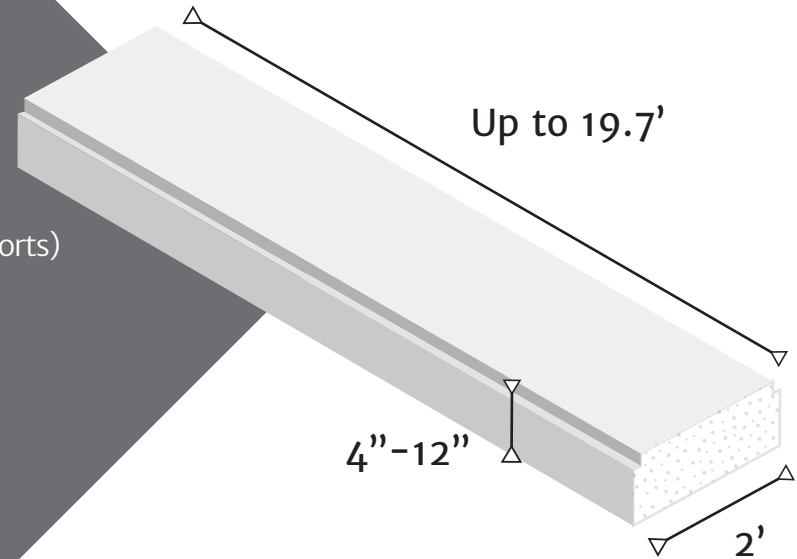

INDUSTRIAL
PANEL





INDUSTRIAL PANEL

DESCRIPTION:

Steel reinforced panel for industrial walls and fences.

ADVANTAGES:

- ☰ Fast Installation
- ☰ Some applications may not require adhesive
- ☰ Thermal, acoustic and fire resistant characteristics, resulting in a comfortable, safe and productive work space

APPLICATION:

Industrial warehouses and fences.

Panels can be attached directly over steel frames, concrete or structural members.

WEIGHT:

12.3 lbs/ft² for 4" thick panel.

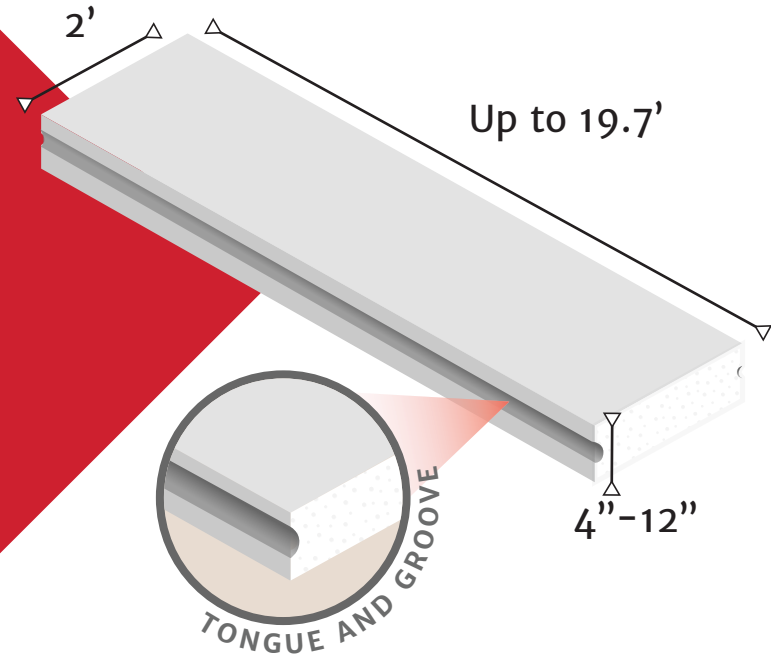

PARTITION
PANEL





PARTITION PANEL

DESCRIPTION:

Steel reinforced demising wall panel. Single panel from floor to ceiling.

ADVANTAGES:

- ≡ Fastest and most efficient installation on the market
- ≡ Supports direct attachment of heavy loads (TV, cabinets, etc.)
- ≡ Solid partition wall, resistant to structural movements, will not drift or deflect
- ≡ Does not require additional reinforcement

APPLICATION:

Non-load bearing partition walls up to 12'.

WEIGHT:

10.7 lbs/ft² for 4" thick panel.

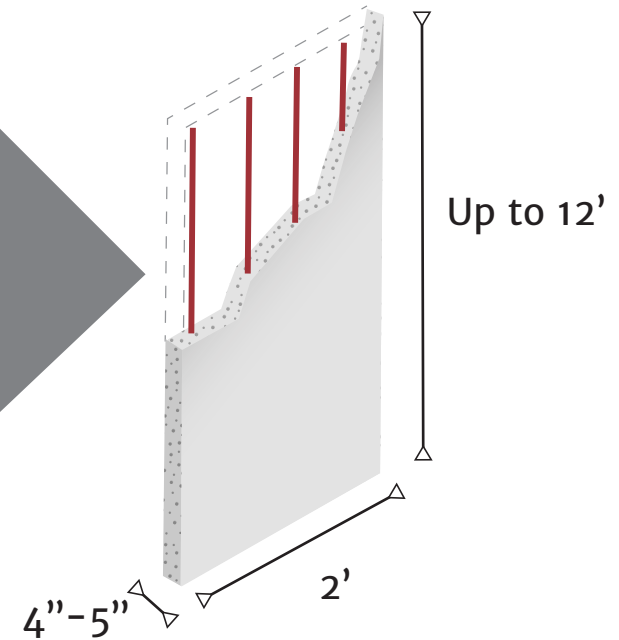

REINFORCED
BLOCK

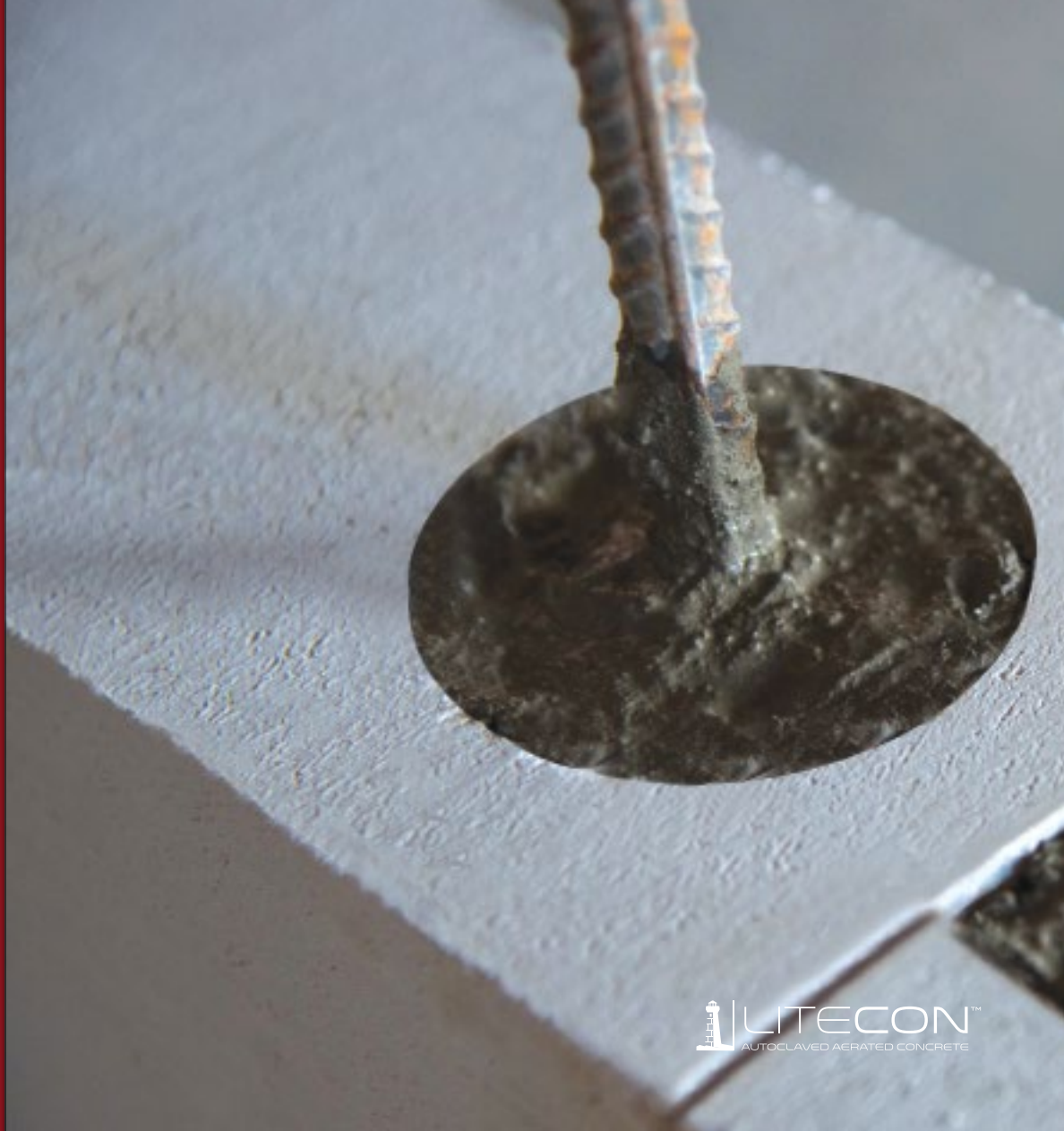

R|B

REINFORCED BLOCK

DESCRIPTION:

Cored blocks to be filled with steel rebar and concrete for load bearing walls.

ADVANTAGES:

- ☰ Does not require additional structural support, no need of beams and columns
- ☰ Savings of 50% in rebar and concrete compared with CMU Block

APPLICATION:

Load bearing, partition and exterior walls.

WEIGHT:

15 lbs/ft² for 5" thick block*.

**Net weight without rebar and concrete.*

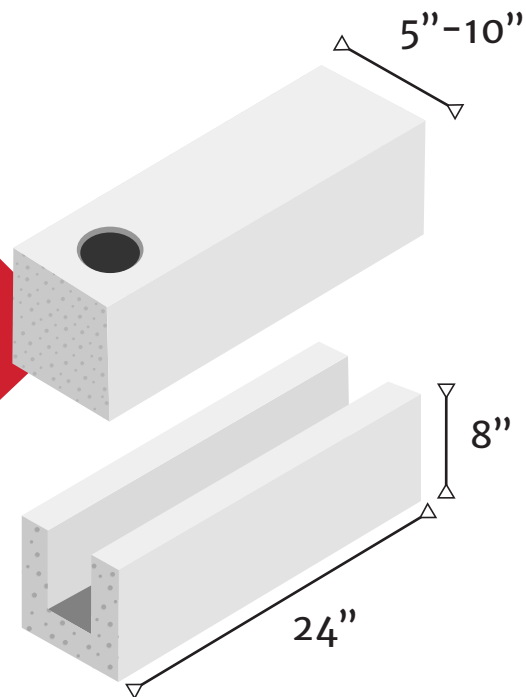

CONFINED MASONRY
BLOCK





CONFINED MASONRY BLOCK



DESCRIPTION:

Solid, lightweight modular block, confined with concrete columns and beams.

ADVANTAGES:

- ≡ 60% lighter than CMU Block
- ≡ Large dimension block
- ≡ Faster installation compared to CMU Block
- ≡ High quality and smooth finish

APPLICATION:

Load bearing and structural walls.

WEIGHT:

12 lb/ft² for 4" thick block.

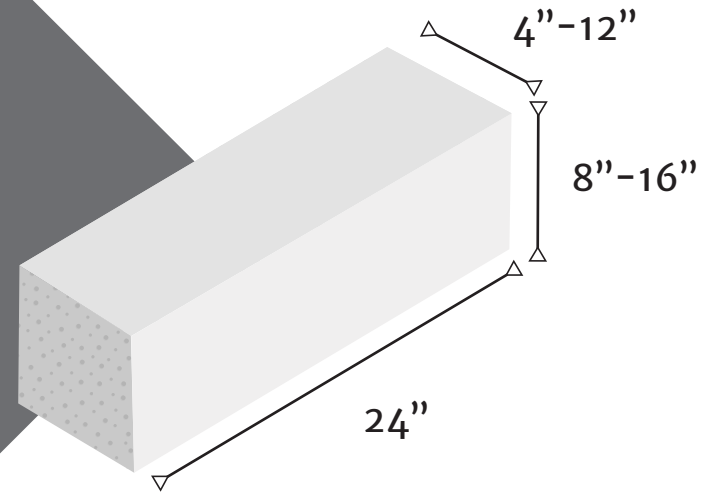



 (210) 605-7052
(210) 616-6390
(210) 668-4545

 info@liteconusa.com

liteconusa.com
