



**SPECIALLY CRAFTED PANEL FOR FIREWALLS.**

Designed for fire resistance, fast installation during framing and high acoustic values.

**ICC-ES Listing Report 1481**

**SPECS**

PARAMETERS	UNITS	VALUES	
		AAC-4	AAC-6
Compressive Strength	psi	590	930
Real Density	lb/ft <sup>3</sup>	33.4	39.2
Elastic Modulus	ksi	326.9	235.5
		VALUES	
Nominal Density	lb/ft <sup>3</sup>	30.4	
Dry Shrinkage	%	0.0015	
Thermal Conductivity	BTU in/h ft <sup>2</sup> °F	0.839	
R Value per Inch	h ft <sup>2</sup> °F/BTU	1.2	
Permeability (μ)	US Perms	6.58	
Moisture Adsorption	Wt%	7.61	



**WORKFORCE PERFORMANCE**

PRODUCT PLACEMENT	PERFORMANCE
2" Firewall Panel	1000 ft <sup>2</sup> per day
3" Firewall Panel	700 ft <sup>2</sup> per day

Work force: 2 installers.

**TESTS**

PARAMETERS	RECORDED MEASUREMENT	RESULTS
Fire Resistance	2 hrs	PASS
Hose Stream	2 min 30 sec	PASS
Sound Transmission Loss	57 STC	PASS

**NOTES:**

1. ASTM E119-20, Standard Test Methods for Fire Tests of Building Construction and Materials.
2. ASTM E2226 - 15b, Standard Practice for Application of Hose Stream.
3. ASTM E90 - Standard Test Method for Laboratory Measurement of Airborne Sound Transmission Loss of Building Partitions and Elements.





**DIMENSIONS**

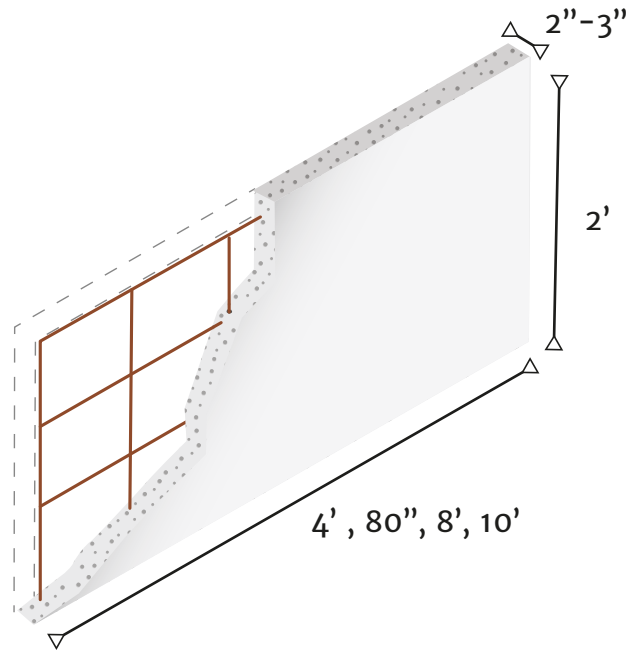

**MEASUREMENTS**

THICKNESS (in)	HEIGHT (in)	LENGTH (in)	AREA (ft <sup>2</sup> )	WEIGHT x PIECE (lb)	WEIGHT x FT <sup>2</sup> (lb)
1.97	24	80	13.33	68.27	5.12
1.97	24	96	16.00	81.92	5.12
1.97	24	120	20.00	102.40	5.12
2.95	24	48	8.00	61.36	7.67
2.95	24	80	13.33	102.27	7.67
2.95	24	96	16.00	122.72	7.67
2.95	24	120	20.00	153.40	7.67



(210) 616-6390  
 (210) 605-7052  
 (210) 668-4545  
 info@liteconusa.com  
 liteconusa.com

Click here for more info:  
[LEED EVALUATION](#)

